

R0249DAA

Figure 234. Front Axle Differential Through Shaft, Gears, and Flange Assemblies.

(1) ITEM NO.	(2) SMR CODE	(3) NSN	(4) CAGEC	(5) PART NUMBER	(6) DESCRIPTION AND USABLE ON CODE (UOC)	(7) QTY
GROUP 1002 DIFFERENTIAL.						
FIG. 234. FRONT AXLE DIFFERENTIAL THROUGH SHAFT, GEARS, AND FLANGE ASSEMBLIES.						
1	PAFZZ	5315-00-059-0184	80205	MS24665-361	PIN,COTTER UOC: DAC,DAD,DAE,DAF,DAG,DAH,DAJ,DAL,DAW,DAX,V14,V15,V16,V17,V18,V19,V20,V21,V22,V24,ZAA,ZAB,ZAC,ZAD,ZAE,ZAF,ZAG,ZAH,ZAJ,ZAL	2
2	PAFZZ	5310-00-282-5661	19207	7346893	NUT,PLAIN,SLOTTED,H UOC: DAC,DAD,DAE,DAF,DAG,DAH,DAJ,DAL,DAW,DAX,V14,V15,V16,V17,V18,V19,V20,V21,V22,V24,ZAA,ZAB,ZAC,ZAD,ZAE,ZAF,ZAG,ZAH,ZAJ,ZAL	2
3	PAFZZ	2520-00-734-6802	19207	7346802	FLANGE,COMPANION,VE UOC: DAC,DAD,DAE,DAF,DAG,DAH,DAJ,DAL,DAW,DAX,V14,V15,V16,V17,V18,V19,V20,V21,V22,V24,ZAA,ZAB,ZAC,ZAD,ZAE,ZAF,ZAG,ZAH,ZAJ,ZAL	2
4	PAFZZ	2520-00-563-8309	19207	7535048	. DEFLECTOR,DIRT AND UOC: DAC,DAD,DAE,DAF,DAG,DAH,DAJ,DAL,DAW,DAX,V14,V15,V16,V17,V18,V19,V20,V21,V22,V24,ZAA,ZAB,ZAC,ZAD,ZAE,ZAF,ZAG,ZAH,ZAJ,ZAL	1
5	PAFZZ	5305-00-018-0178	24617	180178	SCREW,CAP,HEXAGON H UOC: DAC,DAD,DAE,DAF,DAG,DAH,DAJ,DAL,DAW,DAX,V14,V15,V16,V17,V18,V19,V20,V21,V22,V24,ZAA,ZAB,ZAC,ZAD,ZAE,ZAF,ZAG,ZAH,ZAJ,ZAL	8
6	PAFZZ	5310-00-515-9627	38597	50-4-18-17-7	WASHER,FLAT UOC: DAC,DAD,DAE,DAF,DAG,DAH,DAJ,DAL,DAW,DAX,V14,V15,V16,V17,V18,V19,V20,V21,V22,V24,ZAA,ZAB,ZAC,ZAD,ZAE,ZAF,ZAG,ZAH,ZAJ,ZAL	8
7	PAFZZ	3040-00-734-6897	78500	A4-3866-J-556	HOUSING PART,MECHAN UOC: DAC,DAD,DAE,DAF,DAG,DAH,DAJ,DAL,DAW,DAX,V14,V15,V16,V17,V18,V19,V20,V21,V22,V24,ZAA,ZAB,ZAC,ZAD,ZAE,ZAF,ZAG,ZAH,ZAJ,ZAL	1

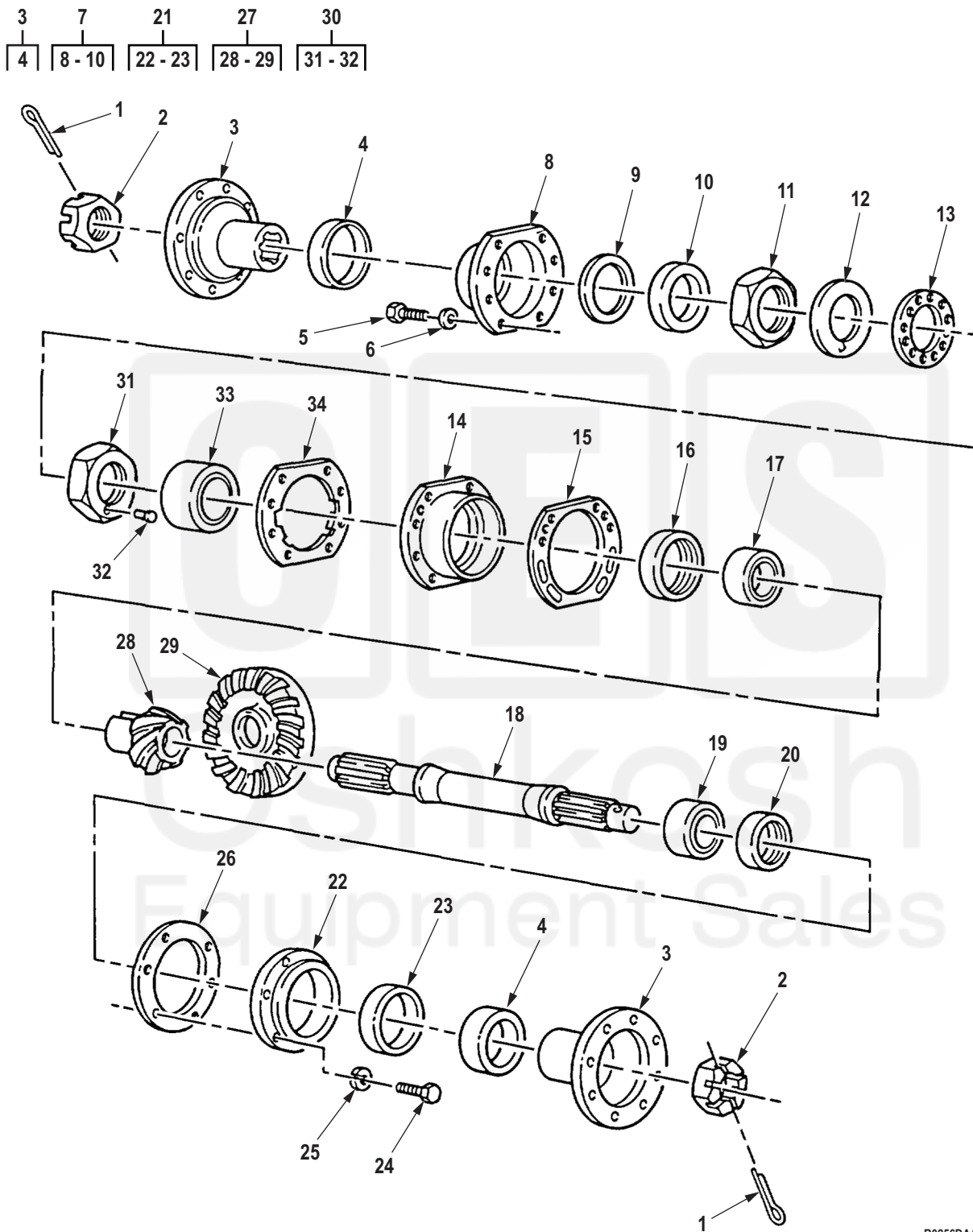

R0256DAA

Figure 241. Rear Axle Differential Through Shaft, Gears, and Flange Assemblies.

(1) ITEM NO.	(2) SMR CODE	(3) NSN	(4) CAGEC	(5) PART NUMBER	(6) DESCRIPTION AND USABLE ON CODE (UOC)	(7) QTY
GROUP 1102 DIFFERENTIAL.						
FIG. 241. REAR AXLE DIFFERENTIAL THROUGH SHAFT, GEARS, AND FLANGE ASSEMBLIES.						
1	PAFZZ	5315-00-059-0184	80205	MS24665-361	PIN,COTTER UOC: DAC,DAD,DAE,DAF,DAG,DAH,DAJ,DAL,DAW,DAX,V14,V15,V16,V17,V18,V19,V20,V21,V22,V24,ZAA,ZAB,ZAC,ZAD,ZAE,ZAF,ZAG,ZAH,ZAJ,ZAL	2
2	PAFZZ	5310-00-282-5661	19207	7346893	NUT,PLAIN,SLOTTED,H UOC: DAC,DAD,DAE,DAF,DAG,DAH,DAJ,DAL,DAW,DAX,V14,V15,V16,V17,V18,V19,V20,V21,V22,V24,ZAA,ZAB,ZAC,ZAD,ZAE,ZAF,ZAG,ZAH,ZAJ,ZAL	2
3	PAFZZ	2520-00-734-6802	19207	7346802	FLANGE,COMPANION,VE UOC: DAC,DAD,DAE,DAF,DAG,DAH,DAJ,DAL,DAW,DAX,V14,V15,V16,V17,V18,V19,V20,V21,V22,V24,ZAA,ZAB,ZAC,ZAD,ZAE,ZAF,ZAG,ZAH,ZAJ,ZAL	2
4	PAFZZ	2520-00-563-8309	19207	7535048	. DEFLECTOR,DIRT AND UOC: DAC,DAD,DAE,DAF,DAG,DAH,DAJ,DAL,DAW,DAX,V14,V15,V16,V17,V18,V19,V20,V21,V22,V24,ZAA,ZAB,ZAC,ZAD,ZAE,ZAF,ZAG,ZAH,ZAJ,ZAL	1
5	PAFZZ	5305-00-018-0178	24617	180178	SCREW,CAP,HEXAGON H UOC: DAC,DAD,DAE,DAF,DAG,DAH,DAJ,DAL,DAW,DAX,V14,V15,V16,V17,V18,V19,V20,V21,V22,V24,ZAA,ZAB,ZAC,ZAD,ZAE,ZAF,ZAG,ZAH,ZAJ,ZAL	8
6	PAFZZ	5310-00-515-9627	38597	50-4-18-17-7	WASHER,FLAT UOC: DAC,DAD,DAE,DAF,DAG,DAH,DAJ,DAL,DAW,DAX,V14,V15,V16,V17,V18,V19,V20,V21,V22,V24,ZAA,ZAB,ZAC,ZAD,ZAE,ZAF,ZAG,ZAH,ZAJ,ZAL	8
7	PAFZZ	3040-00-734-6897	78500	A4-3866-J-556	HOUSING PART,MECHAN UOC: DAC,DAD,DAE,DAF,DAG,DAH,DAJ,DAL,DAW,DAX,V14,V15,V16,V17,V18,V19,V20,V21,V22,V24,ZAA,ZAB,ZAC,ZAD,ZAE,ZAF,ZAG,ZAH,ZAJ,ZAL	1